

R749T



Energy
Management

Cylinder extension for ball valve's handles

Datasheet
0500EN 02/2024



Cylinder extension for ball valve handles, to allow operation even when insulation is installed.
The cylinder can also be mounted on already installed ball valves without stopping the flow of fluids circulating in the system.

➤ Versions and product codes

PRODUCT CODE		USE ON BALL VALVES
BRASS FINISH	CHROME PLATED	
R749TY101	R749TX101	For all the ball valves of 3/8", 1/2"
R749TY102	R749TX102	For all the ball valves of 3/4", 1", 1-1/4"
R749TY103	R749TX103	For all the ball valves of 1-1/2", 2"
R749TY004	R749TX004	For ball valves R850, R250D of 2-1/2", 3"
R749TY005	R749TX005	For ball valves R910 of 2-1/2", 3", 4" and R850, R250D of 4"

► Technical data

Materials

- Internal stem, cylindrical protection extension, stem washer: CW617N - UNI EN 12165 brass.
- Stuffing box ring: PTFE.

► Components

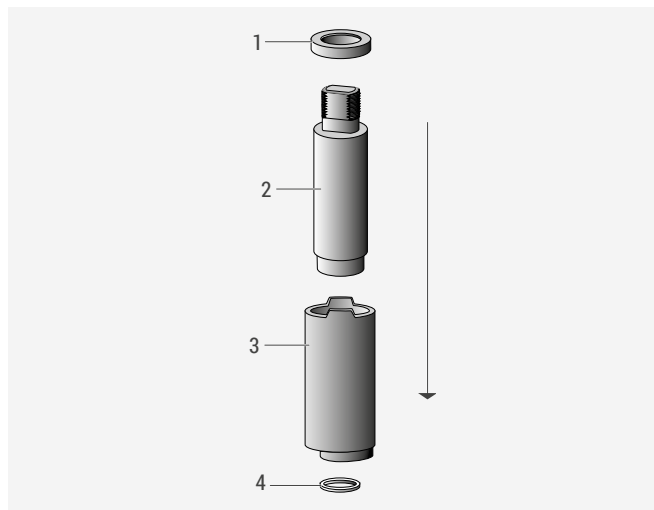

1	Stem washer
2	Stem
3	Separator
4	Stuffing box ring

► Installation

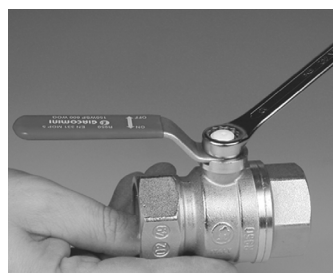

- 1)** Unscrew the nut with the appropriate key.

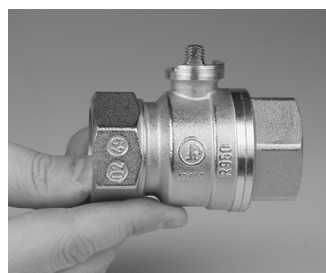

- 2)** Remove the lever and put the new PTFE stuffing box ring (included into the packaging) without removing the existing one.



- 3)** Install the cylindrical extension of the pin, that must be fitted in on the stem of the ball valve, paying attention to the opening direction.



- 4)** On the stem of the ball valve, screw the central pin of the R749T universal extension. and use the lever of the ball valve, to screw deeply.



- 5)** Insert the brass washer (included into the packaging).

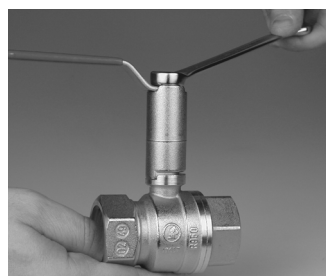

- 6)** Mount the lever and screw the nut by using the appropriate key.

➤ Dimensions

PRODUCT CODE		A [mm]	B [mm]	C [mm]	D [mm]	Dmax [mm]
BRASS FINISH	CHROME PLATED					
R749TY101	R749TX101	M8	M8	20	40	50
R749TY102	R749TX102	M8	M8	24	50	61
R749TY103	R749TX103	M12	M12	29	65	81
R749TY004	R749TX004	M16	M16	31	70	93
R749TY005	R749TX005	M16	M16	36	85	107

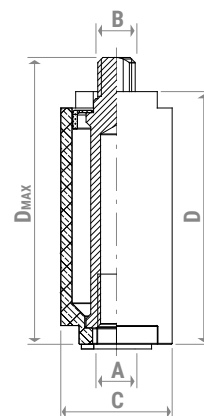

➤ Product specifications

R749T

Cylinder extension for ball valve handles, to allow operation even when insulation is installed. The cylinder can also be mounted on already installed ball valves without stopping the flow of fluids circulating in the system. Internal stem, cylindrical protection extension, stem washer: CW617N - UNI EN 12165 brass. Stuffing box ring: PTFE.

⚠ Safety Warning. Installation, commissioning and periodical maintenance of the product must be carried out by qualified operators in compliance with national regulations and/or local standards. A qualified installer must take all required measures, including use of Individual Protection Devices, for his and others' safety. An improper installation may damage people, animals or objects towards which Giacomini S.p.A. may not be held liable.

♻ Package Disposal. Carton boxes: paper recycling. Plastic bags and bubble wrap: plastic recycling.

ℹ Additional information. For more information, go to giacomini.com or contact our technical assistance service. This document provides only general indications. Giacomini S.p.A. may change at any time, without notice and for technical or commercial reasons, the items included herewith. The information included in this technical sheet do not exempt the user from strictly complying with the rules and good practice standards in force.

♻ Product Disposal. Do not dispose of product as municipal waste at the end of its life cycle. Dispose of product at a special recycling platform managed by local authorities or at retailers providing this type of service.