

MUCProg – GSM configuration Software

- de** Einbau- und Betriebsanleitung
- en** Installation and operating instructions

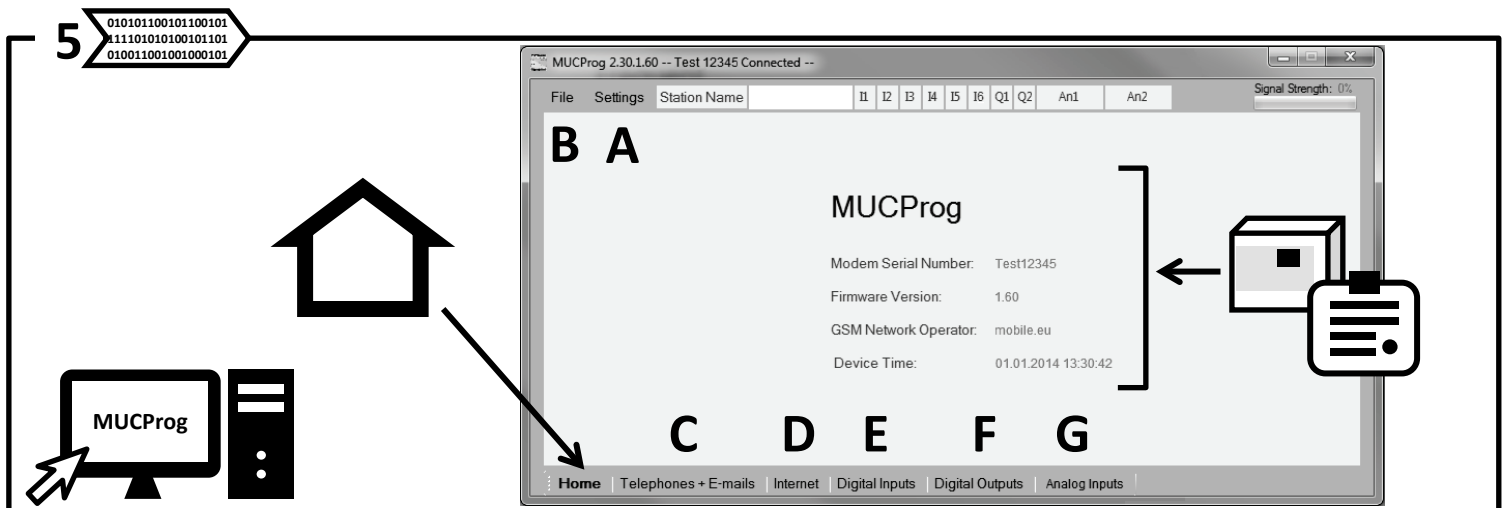

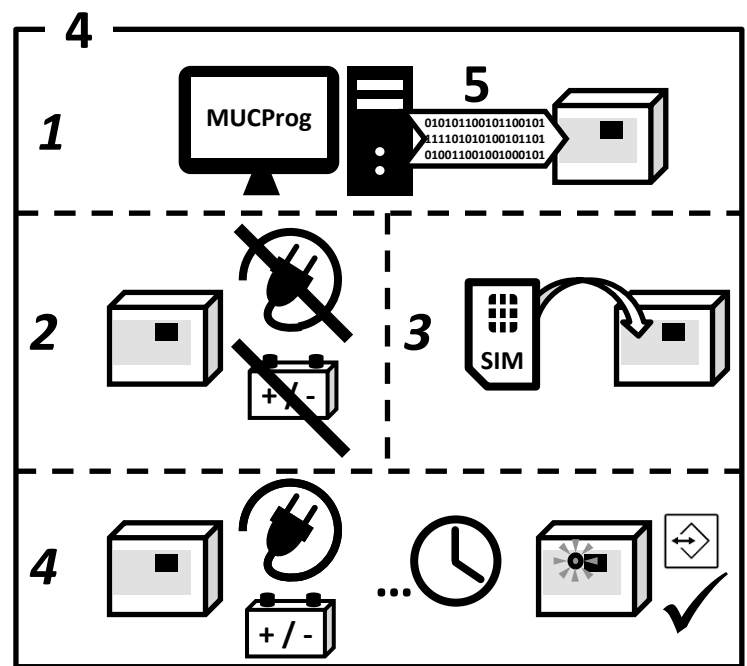
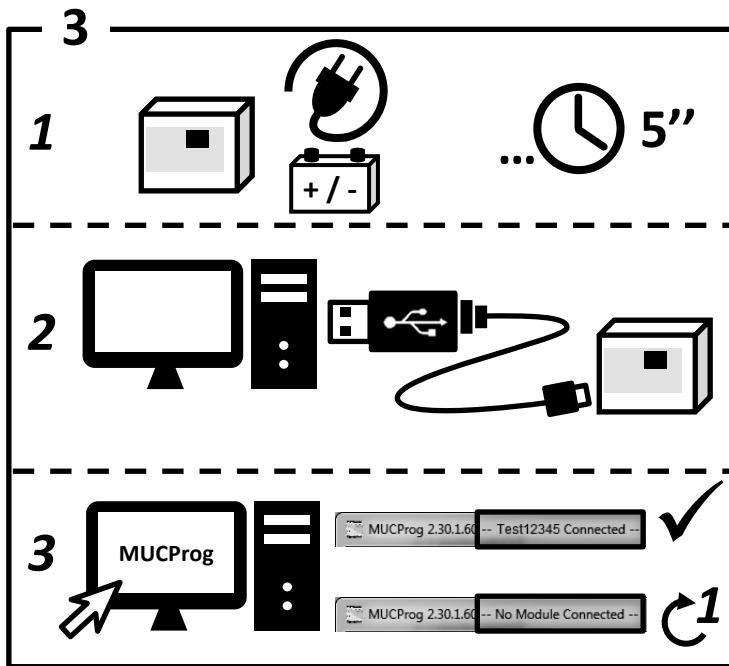
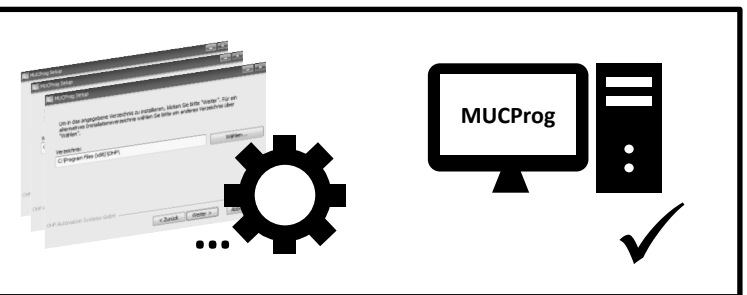
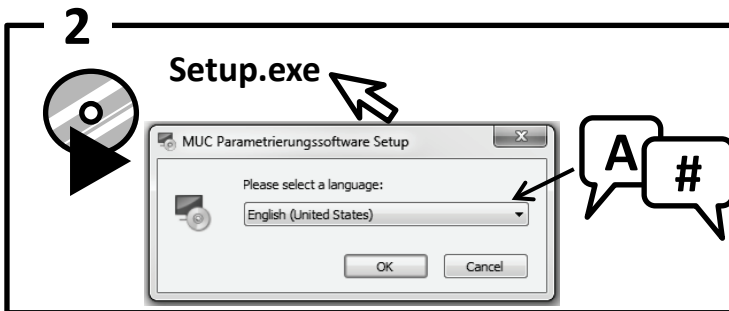
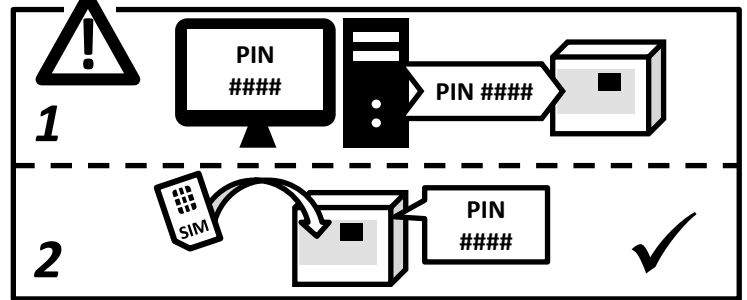
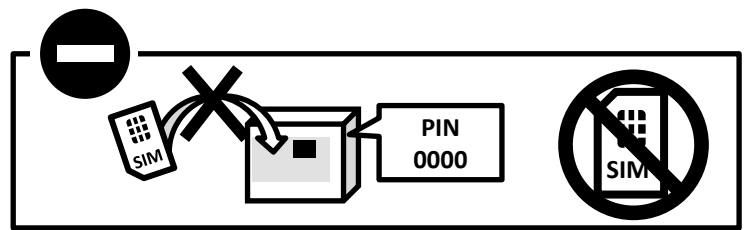
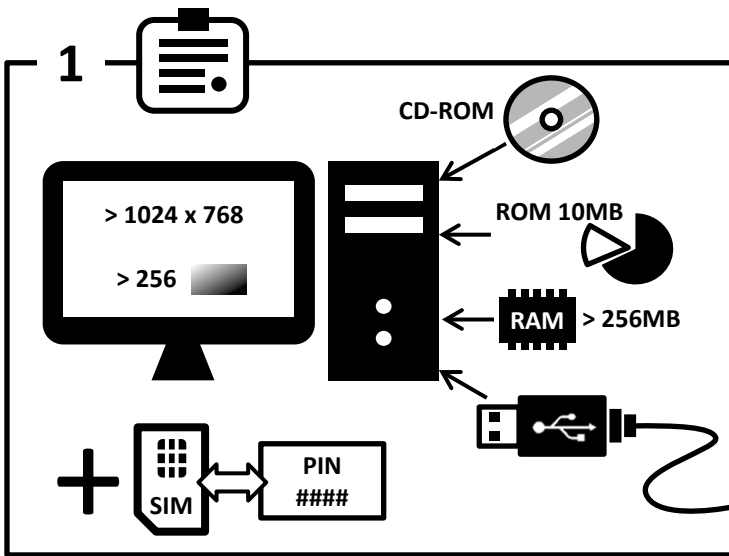

A 010101100101100101
111101010100101101
010011001001000101

File Settings Station Name

- Change Language
- Change Logo
- Set SIM-PIN
- Synchronize Clock
- Enable Power Saving
- Upgrade Product

Logo
230p x 65
.PNG/.JPEG

PIN ?

PIN ?

SIM PIN

SIM PIN ####

B 010101100101100101
111101010100101101
010011001001000101

File Settings Station Name

- Open
- Save As..
- Send To Device
- Read From Device
- Close

010101100101100101
111101010100101101
001001100100100010

010101100101100101
111101010100101101
001001100100100010

010101100101100101
111101010100101101
010011001001000101

010101100101100101
111101010100101101
010011001001000101

www.

SMS Service #

E-mail Service #

E-mail Service ID

C 010101100101100101
111101010100101101
010011001001000101

Telephone Numbers

- No. 1: +49123456789 ✓
- No. 2: = SIM
- No. 3: 0123456789
- No. 4: 00_49_(0)123_45_67

Output

GSM Provider Settings

Select Operator: new operator

SMS Service Number: +49123456789 ✓

E-mail Send Number: +49123456789

E-mail Receive Number: address

Command: CODE

Command Tel. No.: 12345

Acknowledgement Time: 0 Minutes (0.255)

E-mail Addresses

- No. 1: address@domain.ext ✓
- No. 2:
- No. 3:
- No. 4:

Timeline diagram showing a sequence of events:

- 0' (0 minutes): Initial state with a warning icon and a clock.
- 1' (1 minute): A notification bell icon appears.
- 1'-255' (1 to 255 minutes): A series of arrows pointing right, representing a sequence of events or data flow.
- Final state: A notification bell icon is shown with a slash through it, indicating a change in status or a final event.

D
 010101100101100101
 11101010100101101
 010011001001000101



Internet Settings

Access Point Name (APN) internet

APN Username

APN Password

Reconnection Interval Every 5 Minutes

Max. Trials per Connection 1

Get Time Over Internet

Time Server ptbtime1.ptb.de

Time Zone UTC+01:00



E
 010101100101100101
 11101010100101101
 010011001001000101

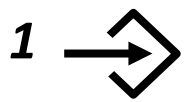

Set Active	Tel. No.	E-mail No.	Message	Input Settings	Assign Output
<input type="checkbox"/> Input 1	none	none		<input type="checkbox"/> Inverted <input type="checkbox"/> Delay Time <input type="checkbox"/> OE	<input type="checkbox"/> Q1 <input type="checkbox"/> Q2
<input type="checkbox"/> Input 2	none	none		<input type="checkbox"/> Inverted <input type="checkbox"/> Delay Time <input type="checkbox"/> OE	<input type="checkbox"/> Q1 <input type="checkbox"/> Q2
<input type="checkbox"/> Input 3	none	none		<input type="checkbox"/> Inverted <input type="checkbox"/> Delay Time <input type="checkbox"/> OE	<input type="checkbox"/> Q1 <input type="checkbox"/> Q2
<input type="checkbox"/> Input 4	none	none		<input type="checkbox"/> Inverted <input type="checkbox"/> Delay Time <input type="checkbox"/> OE	<input type="checkbox"/> Q1 <input type="checkbox"/> Q2
<input type="checkbox"/> Input 5	none	none		<input type="checkbox"/> Inverted <input type="checkbox"/> Delay Time <input type="checkbox"/> OE	<input type="checkbox"/> Q1 <input type="checkbox"/> Q2
<input type="checkbox"/> Input 6	none	none		<input type="checkbox"/> Inverted <input type="checkbox"/> Delay Time <input type="checkbox"/> OE	<input type="checkbox"/> Q1 <input type="checkbox"/> Q2

Abcd [max. 20]

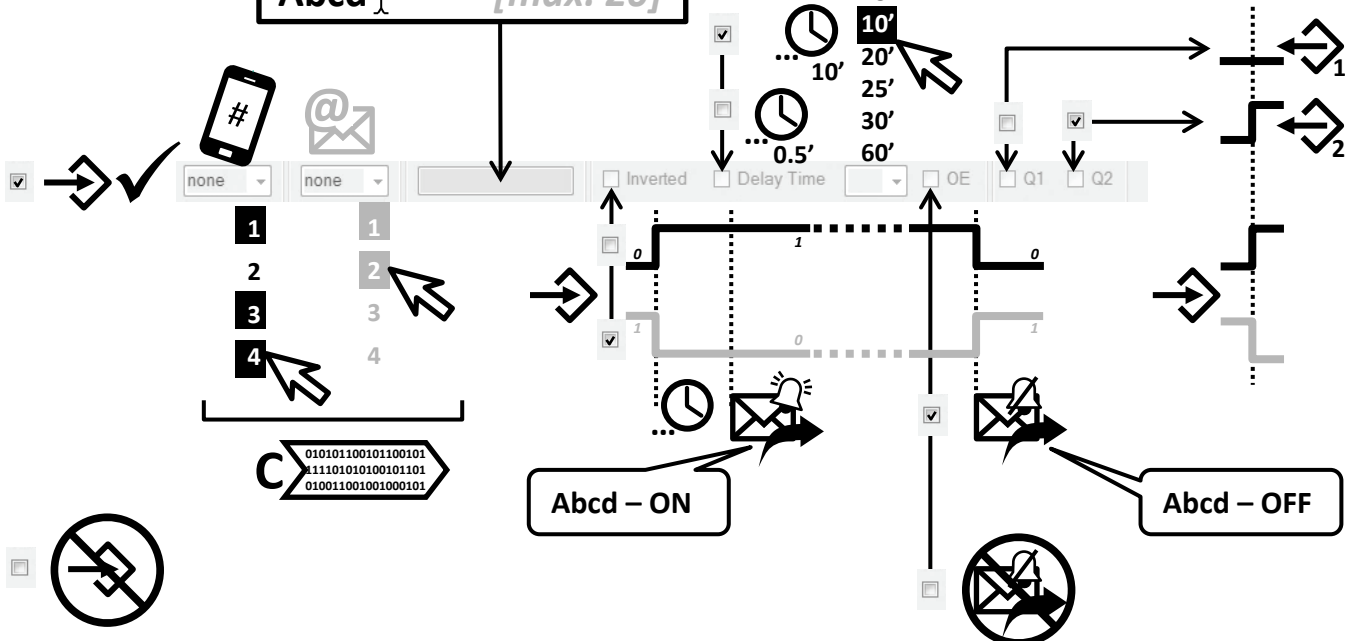

C
 010101100101100101
 11101010100101101
 010011001001000101

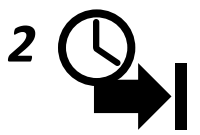





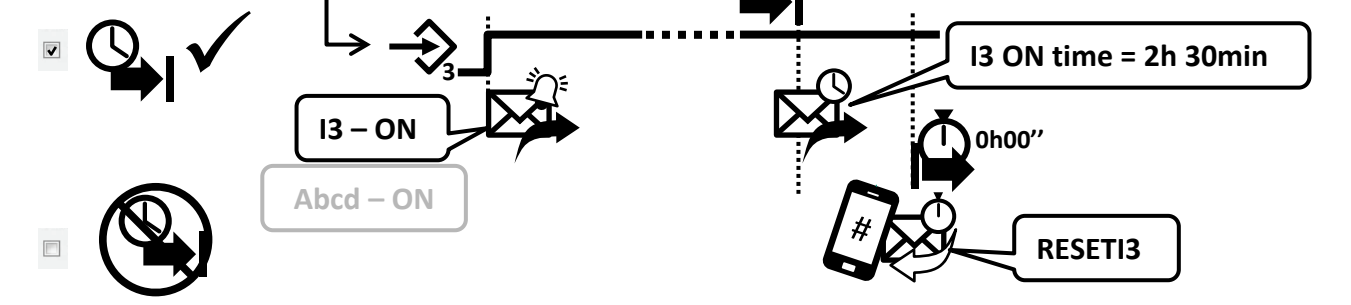

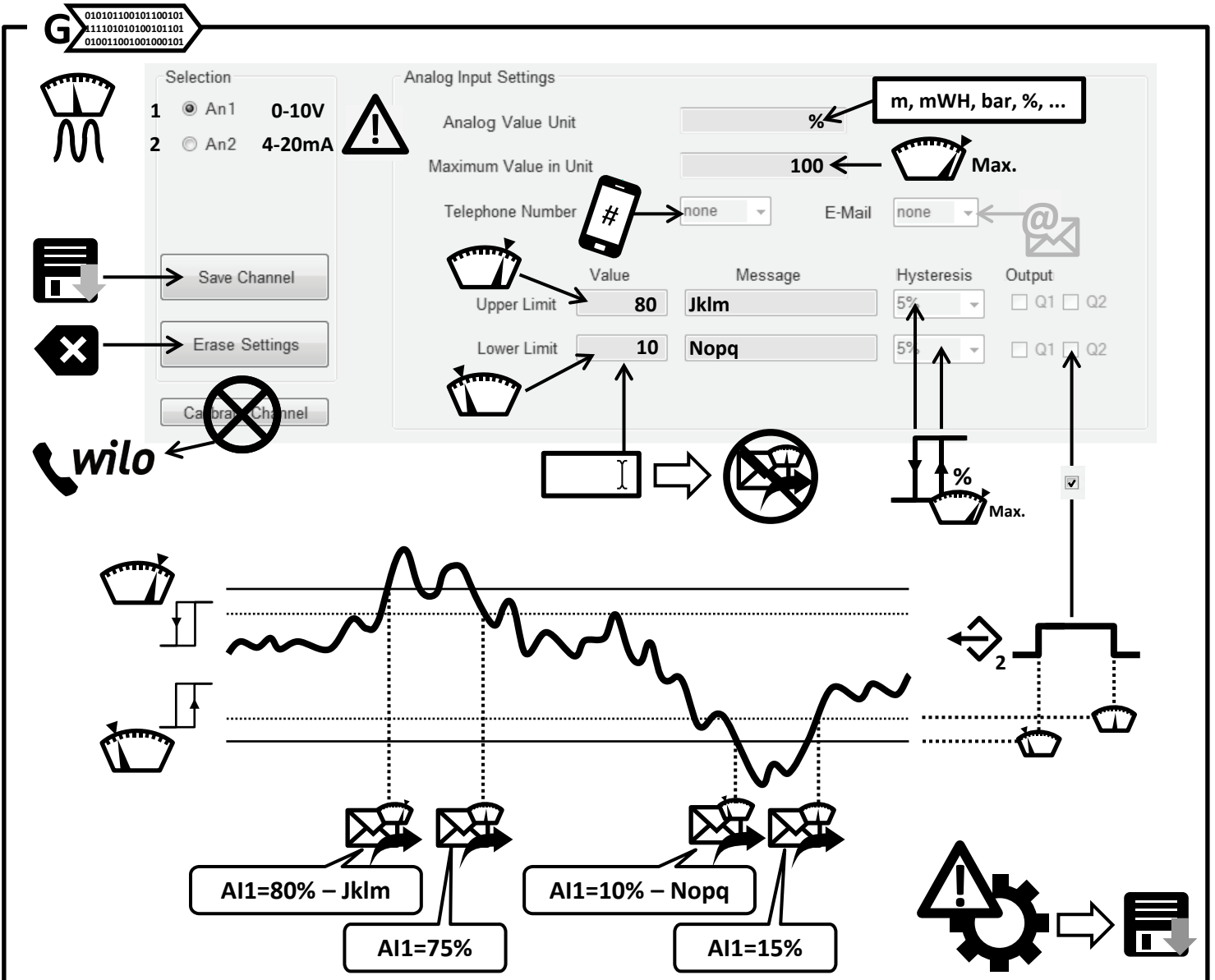
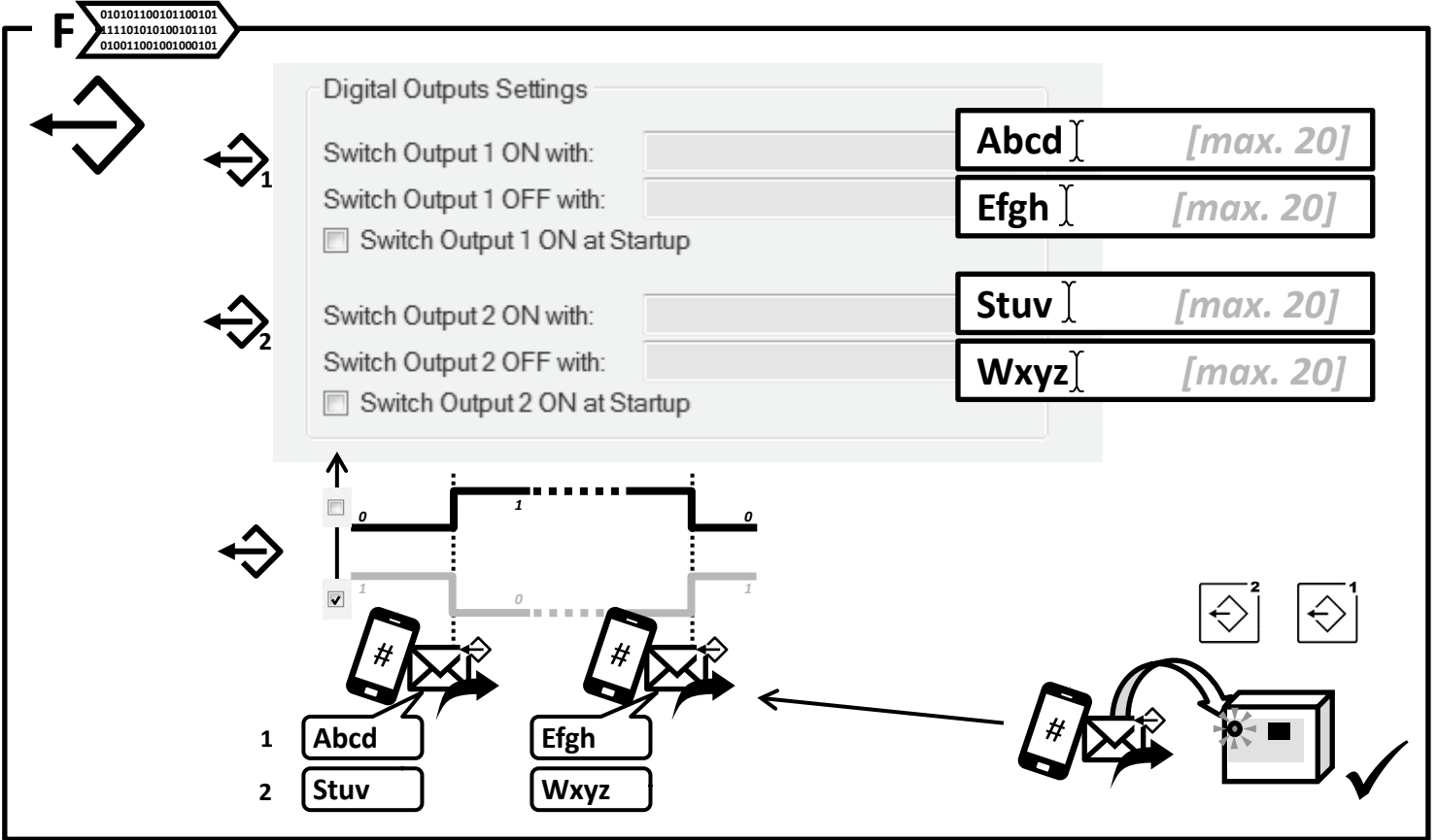





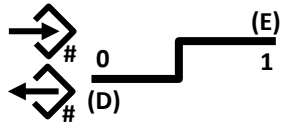

Power-On Hours Borders

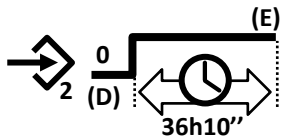
<input type="checkbox"/> Input 1	Hours	Minutes	<input type="checkbox"/> Input 4	Hours	Minutes
<input type="checkbox"/> Input 2	Hours	Minutes	<input type="checkbox"/> Input 5	Hours	Minutes
<input checked="" type="checkbox"/> Input 3	2	30	<input type="checkbox"/> Input 6	Hours	Minutes

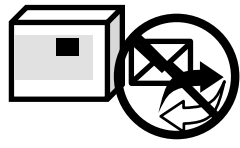



<p>6 </p> 		
<p>HELP Help help</p>	<p>GETDIGISTATE, GETANASTATE, GETTEMPSTATE, GETPOHSTATE, RESETIX, SMSON, SMSOFF</p>	
<p>GETSTATUS</p>	<p>SERIAL NUMBER: 00000000000000000000 FrmVer: 00.00-000 ACCU: 00.00V (S) MAIN: 00.00V</p>	
<p>GETDIGISTATE</p>	<p>I1=0, I2=1, I3=0, I5=0, I6=0, Q1=0, Q2=0</p>	
<p>GETANASTATE</p>	<p>AI1=000000, AI2=000080</p>	
<p>GETPOHSTATE</p>	<p>I1=00000H_00M(D) I2=00036H_10M(E) I3=00000H_00M(D) I4=00000H_00M(D) I5=00000H_00M(D) I6=00000H_00M(D)</p>	
<p>RESETI# [# = 1-6]</p>	<p>TIME I#=0 (D)</p>	
<p>SMSON</p>	<p>SMSON</p>	
<p>SMSOFF</p>	<p>SMSOFF</p>	
<p>XR?GWS!#</p>	<p>ERROR unknown order</p>	
<p> GETIOSTATE</p>	<p>I1=0, I2=1, I3=0, I5=0, I6=0, AI1=00000, AI2=00000 Q1=0, Q2=0</p>	

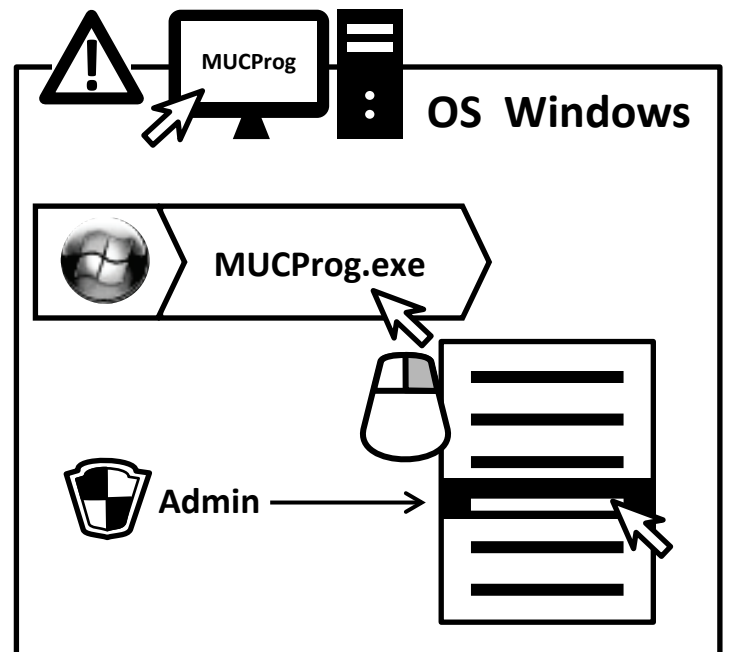
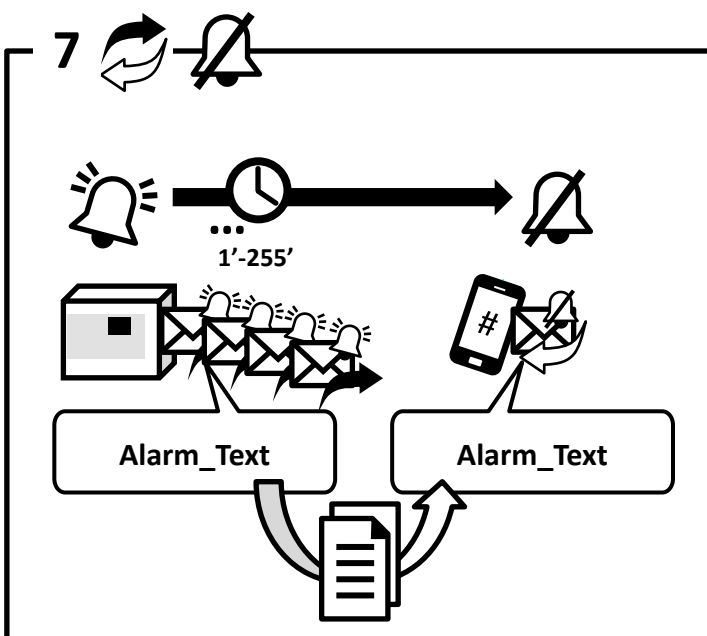

wilo

Pioneering for You

WILO SE
Nortkirchenstraße 100
44263 Dortmund
Germany
T +49 (0)231 4102-0
F +49 (0)231 4102-7363
wilo@wilo.com
www.wilo.com